

Fuse cartridge AD

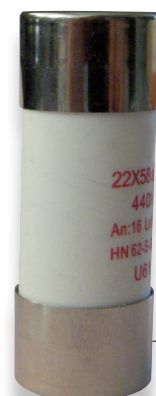

Application

These AD fuse cartridges are used together with the circuit-breaker installed on the individual service tap connection. They perform the cutoff for high short-circuit currents and thereby extend the service life of the associated circuit-breaker, which is not overloaded up to the limit.

Cylindrical cartridge

Description

- This fuse cartridge is available in several sizes: 10.3x38, 14x51 and 22x58mm.
- Many models are available according to the circuit breaker nominal current to which it must be connected: AD 15A, AD 30A, AD 45A, AD 60A and AD 90A.
- Low power loss limits heating of the device holding the fuse and extends its service life.
- It is specified for a nominal voltage of 440V in alternating current with nominal frequency of 50Hz.
- The nominal breaking capacity is 20kA.

This fuse meets the criteria of the **HN62-S-83**, **NF/EN/IEC 60269-1**, **NF HD/IEC 60269-2**, **NF C 60200-1** and **NF C 60200-2** standards.

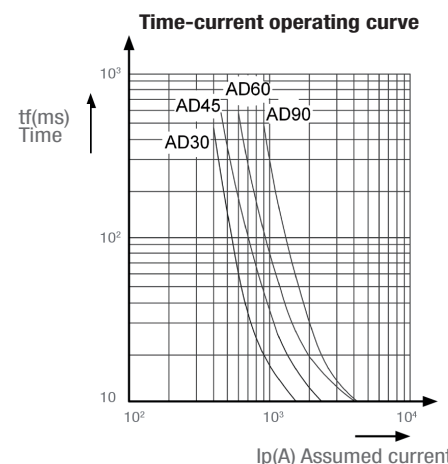

Code	Designation	Weight (kg)	Sales unit
FUSE CARTRIDGE 10.3x38mm			
U618	FUSE CARTRIDGE 10.3X38 AD 5A	0.009	10
U619	FUSE CARTRIDGE 10.3X38 AD 10A	0.009	10
U623	FUSE CARTRIDGE 10.3x38 AD 15A	0.009	10
U620	NEUTRAL TUBE 10.3x38	0.012	10
FUSE CARTRIDGE 14x51mm			
U615	FUSE CARTRIDGE 14x51 AD 15A	0.021	10
U616	FUSE CARTRIDGE 14x51 AD 30A	0.021	10
U617	FUSE CARTRIDGE 14x51 AD 45A	0.021	10
U621	NEUTRAL TUBE 14x51	0.016	10
FUSE CARTRIDGE 22x58mm			
U610	FUSE CARTRIDGE 22x58 AD 15A	0.056	10
U611	FUSE CARTRIDGE 22x58 AD 30A	0.056	10
U612	FUSE CARTRIDGE 22x58 AD 45A	0.056	10
U613	FUSE CARTRIDGE 22x58 AD 60A	0.056	10
U614	FUSE CARTRIDGE 22x58 AD 90A	0.056	10
U622	NEUTRAL TUBE 22x58	0.028	10

Note: Other 10.3x38, 14x51, 22x58 fuses can be supplied upon request: please contact us.

Fuse cartridge size 00



Description

- The size of this blade fuse cartridge is 00 according to the **IEC 60269-2-1** standard.
- There are 4 models available according to the nominal current of the circuit-breaker to which it must be connected: AD 30A, AD 45A, AD 60A and AD 90A.
- The fixing brackets are made of insulating synthetic materials.
- The accessible metal parts (screws), with the exception of the blades, are potential free and also have the degree of protection IP2X according to the **NF EN 60529** standard.
- Low power loss limits heating of the device holding the fuse and extends its service life.
- It is specified for a nominal voltage of 440V in alternating current with nominal frequency of 50Hz.
- The nominal breaking capacity is 20kA.

This fuse meets the criteria of the **HN62-S-83** standard.

P24x

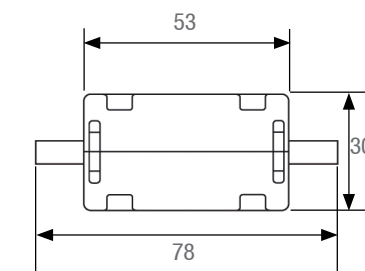
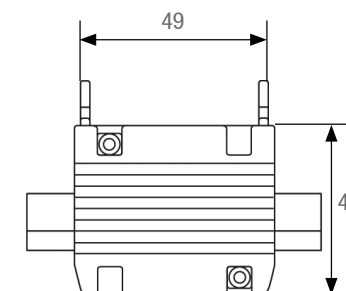

P240

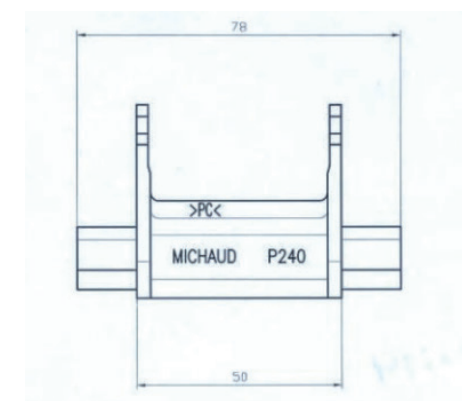

Dimensions in mm

Code	Designation	Resistance to 20°C (μΩ)	Consumption (W)	Blade temperature rise (°K)	Weight (kg)	Sales unit
P241	FUSE CARTRIDGE SIZE 00 AD 30A	1150	1.4	9	0.150	10
P242	FUSE CARTRIDGE SIZE 00 AD 45A	740	2.1	16	0.150	10
P243	FUSE CARTRIDGE SIZE 00 AD 60A	650	3.3	20	0.150	10
P244	FUSE CARTRIDGE SIZE 00 AD 90A	430	5.1	34	0.150	10
P240	NEUTRAL BLADE CONTACT SIZE 00				0.060	10